

### Statement:

Interlocking relay module is an implement for two doors egress controlling, simply for fail-safe version electrified locking devices which come with signal output to integrate lock 1 and lock 2 alternately from changeover relays build in ILM-100, consequentially on all-inclusive sites application.

### Specifications:

Case Size: 88(L)X88(W)X35(D) mm  
 for Common Europe single-gang box sized  
 Relay rated 3A@125Vac, 24Vdc  
 12~24 V DC power input, input equivalent to Output voltage.  
 (Lock-1, Lock-2 contact output)  
 Operating Temper.: - 20~+70 C  
 Humidity: 0~95% non-condensing.

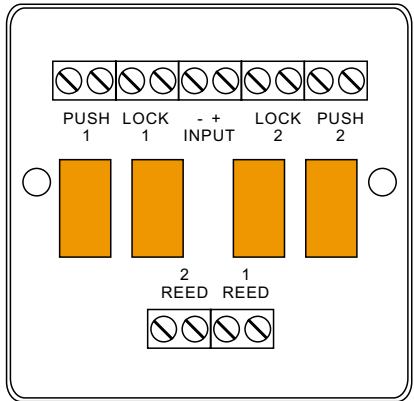

### Schematic to make use of ILM-100 Interlocking Relay Module on sites

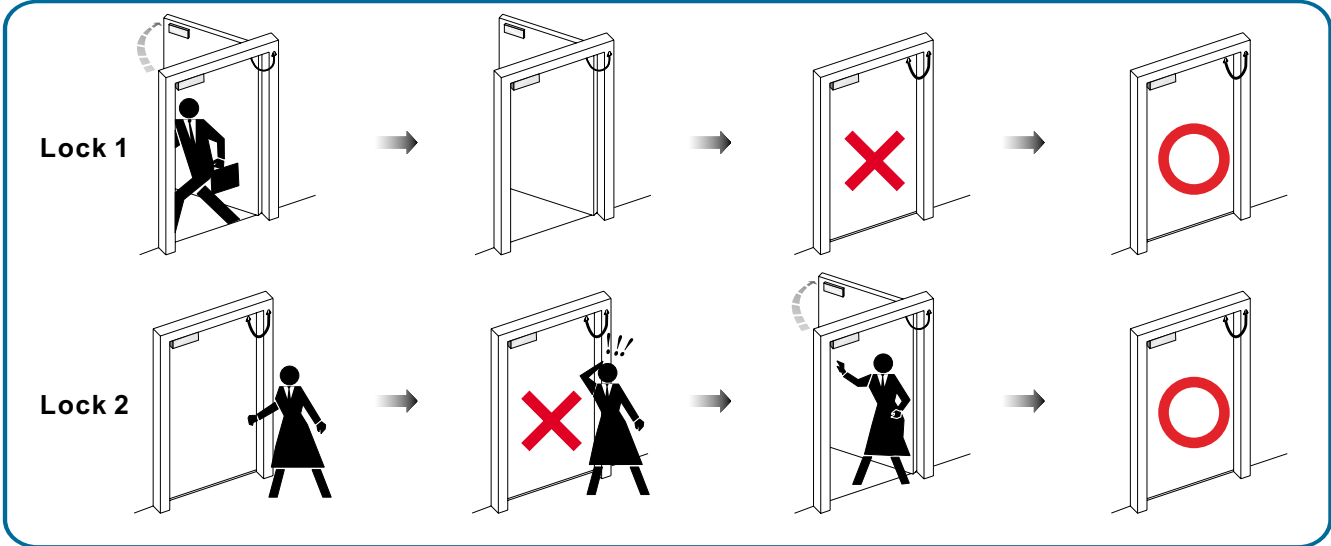

Upon both doors closed (Lock 1 and 2), any of the Lock 1 or 2 on door been opened (for example: Lock 1), the other lock remains (Lock 2) on door will not be able to open at the same time, until the opened door (Lock 1) been closed. Or, the alternation of Lock 1 and Lock 2 on doors taking its turns to feature of Interlocking perfectibility.



### Connecting Diagram:

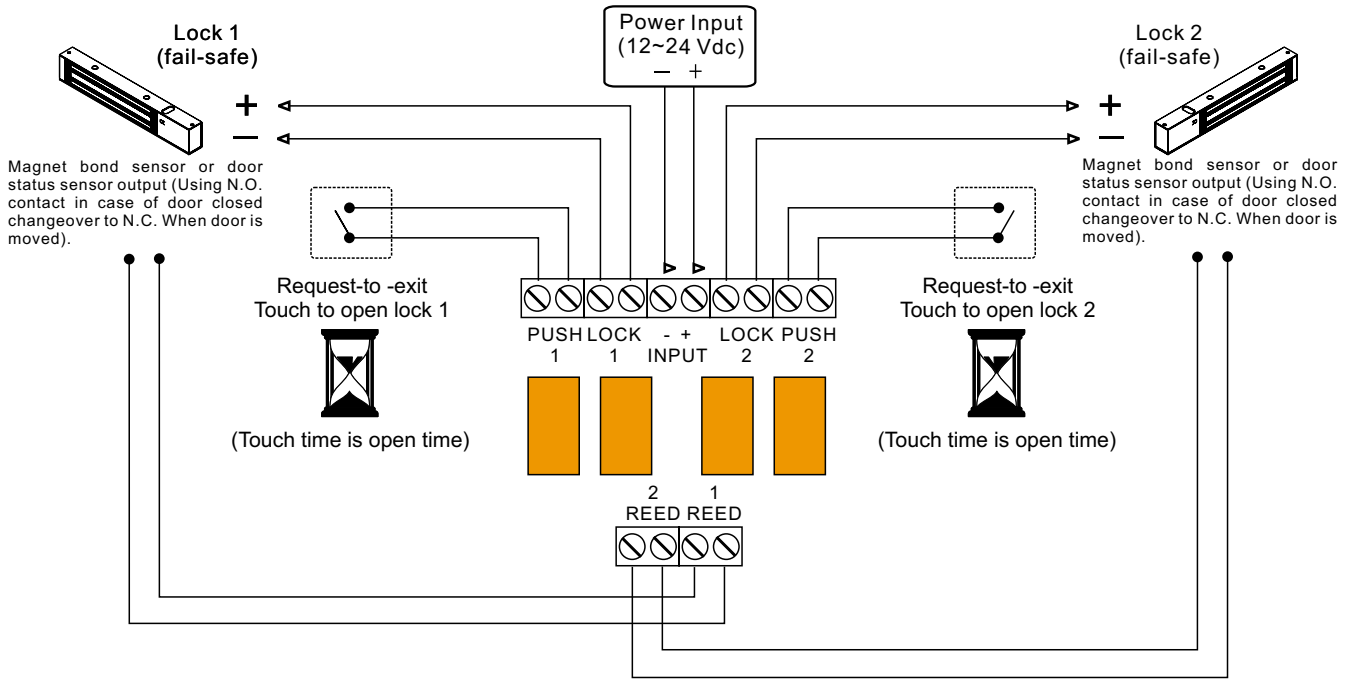

#### NOTE:

1. Interlocking relay module is an implement for **two doors** egress controlling and for **fail-safe** version electrified locking devices.
2. Input equivalent to Output (**Lock-1, Lock-2 contact** output) voltage.
3. The electrified locking devices qualify for the function is indispensable of **lock status sensor** or **door position sensor output** to indicates locked/unlocked or opened/closed.

#### Warranty:

GEM access control related accessories are warranted against defects in material and workmanship while used in normal service for a period of 1 year from the date of sale to the original customer.

#### Disclaimer:

The information and specifications printed in this manual are current at the time of publication. The GEM policy is one of continual development and improvement; therefore GEM reserves the right to change specifications without notice.

**GIANNI INDUSTRIES, INC.**

No.306-1, Hsin Shu Road, Hsin Chuang, Taipei, Taiwan 242  
 TEL: 886-2-2206 9929 FAX: 886-2-2204 6632  
 E-Mail: info@gianni.com.tw  
 Website: www.gianni.com.tw

Copyright all rights reserved  
 DM-CA-2004-ILM-100 Ver. B Publish:2005.12.22



The products are manufactured under an ISO 9001 Certified Quality Management Program environment back its product quality, performance and commitment to customer satisfaction.